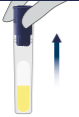

SWIPPER™**DISCREET
DRUG TEST****General Screening
Drugs
Test Kits****SW-9000****Read
Before
Use**

As a precaution, gloves and eye protection should be worn when handling substances and using test units. Do not puncture any part of unit. Do not remove probe after breaking the ampule. In event of a spill, rinse affected area thoroughly with water. Keep out of reach of children. Store the tubes in a dark place, not exposed to light. All results are presumptive. If necessary, further testing by a competent drug testing lab can provide additional identification.

Test Preparation**1**

Remove the SWIPPER™ Cap from the test unit.

**Ensure that the test tube remains upright in order to avoid the ampule falling out of the tube.****2**

Sample the suspected substance with the SWIPPER™ Cap.

**Test Preparation****3**

Return the SWIPPER™ Cap to the test tube. Press firmly.

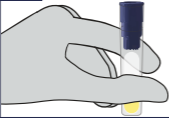
**STOP****Do not continue unless the SWIPPER™ Cap is properly secured.****Identification****4**With **thumb and forefinger**, squeeze the test tube until the ampule breaks.**5**

Gently shake test up and down to ensure that the liquid touches the Cap.

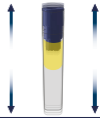
**Results**

The immediate appearance of a purple-red color indicates the presence of one of the following drugs:

Heroin, Amphetamine, Methamphetamine, Ecstasy/MDMA, Benzedrone, Buphedrone, Carfentanyl, Cathinone, DMT, EAPB, Fentanyl, Ketamine, LSD, mCPP, MDMAI, MDPBP, MDPV, Mephedrone, Methadone, Methcathinone, Methylone, Mexedrone, MPA, PCP, Pentedrone, Pentylone, PMA, PMMA, Psilocybin, 2-aminoindane (2-AI), other synthetic/designer drugs.The immediate appearance of a green or blue-green color indicates the presence of **Cocaine or Crack**.If **none** of the above colors develop, the above listed drugs are **not** present.**Disposal**

The test kit is safe to dispose of in the trash.

30001
01-21**IDenta**
Detection Solutionswww.getswipper.comManufactured by IDenta Ltd
Patented Technology • Made in Israel